

AT A GLANCE

FEATURES

- Stylish top mount control
- Single action design (one lever for throttle one for shift)
- CH5600P patented SLT technology prevents throttle creep
- Superior twin station performance
- Polished stainless steel levers and cover
- Positive detents for shift
- Push or pull to operate throttle and/or shift
- Includes hardware for two 33C type cables
- Optional neutral safety switch

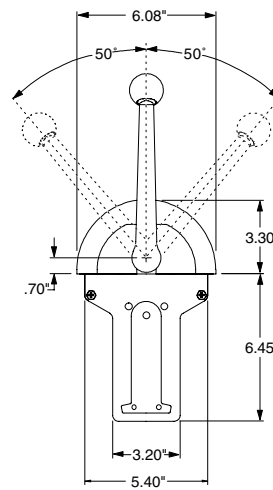
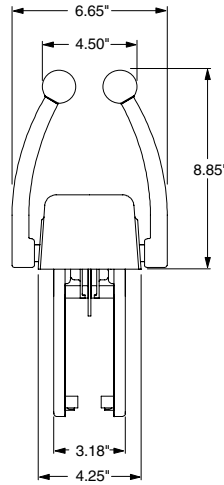

CH5600P TOP MOUNT CONTROLS

TECHNICAL DATA

For single or dual stations with single or twin engines. One control per engine per station. Using a patented self locking throttle clutch (SLT), the CH5600P control fights throttle creep without friction devices, for a smoother feel.

SPECIFICATIONS

ORDER INFORMATION	PART NO.
CH5600P SLT top mount control	CH5600P

ACCESSORIES AND PARTS	PART NO.
Optional neutral safety switch	CA69009P
Cable attachment kit (3300/dual sta)	CA69022P
3300 heavy duty brass pivot kit	CA27563P
Replacement red knob	4009912**
Replacement black knob	4009819**
Stainless steel throttle knob (grooved)	CA69052P**
Stainless steel shift knob (smooth)	CA69051P**
CH5600 mounting hardware kit	CA69013P
Replacement stainless steel lever	CA69060P

COMPATIBLE CABLES	PART NO.
OEM/Univ. 3300 Types	
Mercury 3600 type cable (premium)	CCX630XX
Universal 3300 Types	
3300 cable (standard)	CC172XX/CC230XX
3300 cable (midrange)	CC332XX
TFXTREME 3300 cable (premium)	CCX633XX

** Fits most controls with 3/8-24 threaded levers

